

# TAP2481 – Lecco

Key:	Description:	APX size (mm):	Base material:	Colour:	QTY:
A1	Aerator housing	17 X 24	Brass	Chrome	1
A2	Aerator	M22	Plastic	Blue/Grey	1
A3	Rubber gasket	21 x 1	Rubber	Black	1
A4	Spout	230 x 24	Brass	Chrome	1
B1	Grub screw and dust cap	M5 x 4 / 7 x 5	Brass/Plastic	Chrome	1
B2	Handle	160 x 28	Brass	Chrome	1
B3	Valve shroud	40 x 11	Plastic	Chrome	1
B4	Valve locking nut	37 x 10	Brass	Brass	1
B5	Valve cartridge	35 x 60	Plastic	Blue	1
C1	Upper body	42 x 38	Brass	Chrome	1
C2	Anti friction ring	40 x 1	PTFE	White	1
C3	Anti friction ring	40 x 1	PTFE	White	1
C4	O-ring	38 x 4	Rubber	Black	1
C5	O-ring	38 x 4	Rubber	Black	1
C6	Body	42 x 38	Steel	Silver	1
C7	Lower body	150 x 42	Brass	Chrome	1
C8	Base plinth	50 x 5	Brass	Chrome	1
C9	Upper seal	2 x 45 OD	Rubber	Black	1
D1	Fixing stud	M8 x 220	Steel	Silver	1
D2	Stabiliser plate	88 x 58	Plastic	White	1
D3	Lower gasket	44 OD x 3	Rubber	Black	1
D4	Metal horseshoe	51 x 5	Steel	Silver	1
D5	Fixing nut	18 x 11 OF	Brass	Brass	1
E1	Hot inlet pipe	370 x 12 x M10	Steel	Silver / red	1
E2	Cold inlet pipe	370 x 12 x M10	Steel	Silver / blue	1
E3	Non return valve	16 x 14	Plastic	White	1
X1	Aerator assembly	N/A	N/A	N/A	1
X2	Handle assembly	N/A	N/A	N/A	1
X3	Fixing kit assembly	N/A	N/A	N/A	1

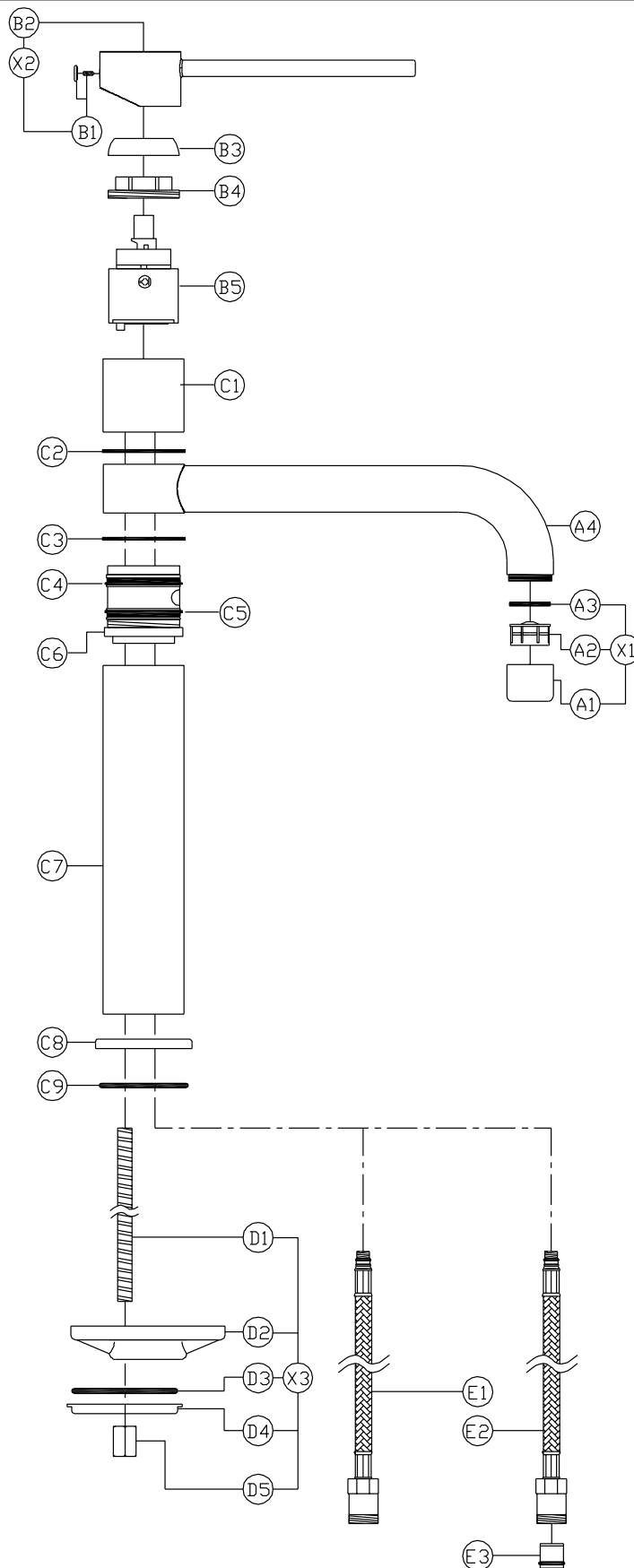

# TAP 2481- lecco service drawing v1

(c) abode home products ltd  
[www.abode.eu](http://www.abode.eu)

our policy is to continually  
improve and develop products,  
and accordingly we reserve the  
right to amend specifications  
without prior notice

**General Advice:**

- These instructions are intended as a guide only, if you are in any doubt you should seek the advice of a qualified professional.
- Take care not to mark finished parts with screwdrivers or other tools.
- Use a pair of rubber gloves to get a better grip on decorative hand tight parts.
- Ensure all parts are reassembled tightly.
- After maintenance test that all assemblies are water tight and function correctly.
- Always isolate the hot and cold water supplies before starting any maintenance, once isolated you should drain any residual water from your system.

**To replace the valve:**

1. Turn the handle (B2) to access the rear side.
2. Remove the dust cap (B1) with a fingernail or small screwdriver.
3. Loosen grub screw (B1) using a 2.5mm A/F Allen key.
4. Pull the handle (B2) vertically away from the tap.
5. Lever away the decorative cover (B3)
6. Hold the upper body of the tap (C1) firmly. Using an adjustable spanner unscrew the valve lock nut (B4).
7. Pull the old valve cartridge (B5) away from the tap.
8. Ensure that the upper body (C1) is clean of dirt and grit.
9. Place the new valve (B5) in the chamber (C5), ensuring the locators on the base of valve (B5) align with the recesses in the chamber of the tap (C5).
10. Reassemble the tap in the reverse order.

**To replace the spout o-rings:**

1. This procedure is easiest if the tap is removed from the sink. Remove the lower body (C7) but leave the tail pipes (E1 & E2) attached to body (C6).
2. Follow steps 1-7 of the valve change procedure.
3. With both tail pipes (E1 & E2) clamped or firmly held across both crimpings unscrew the body (C6).
4. push the spout (A4) upwards and off the body (C6)
5. Remove the old o-rings (C4 & C5) using a small screwdriver or similar. Note the orientation of the o-rings for reassembly.
6. If worn, remove the white PTFE spacers (C2 & C3).
7. Ensure the inside of the spout (A4) and the body (C6) is clean of dirt and grit.
8. If required locate the new white PTFE spacers (C2 & C3).
9. Carefully locate the new O-rings (C4 & C5) onto the body (C6).
10. Grease the O-rings thoroughly with silicone or alternative similar grease.
11. Reassemble the tap in the reverse order.